

100AG TIMBER FLOOR/DECK Standard installation

When 100AG is running parallel to joist/bearer

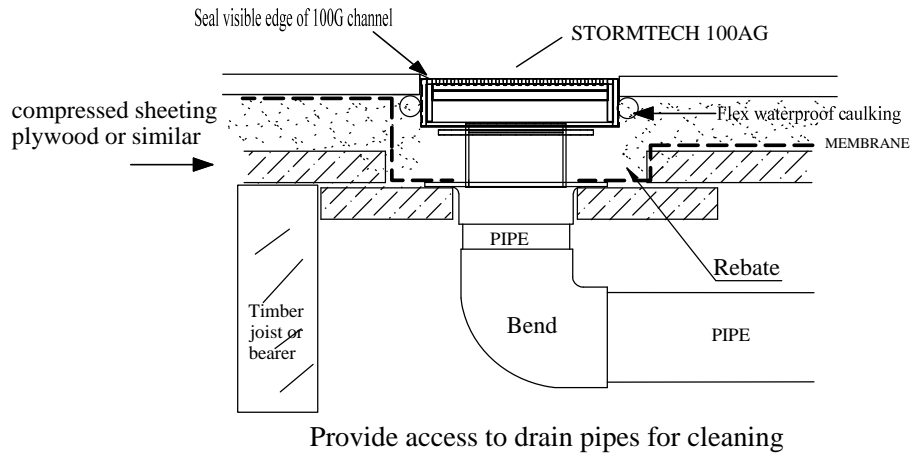

When 100AG is running perpendicular to joist/bearer

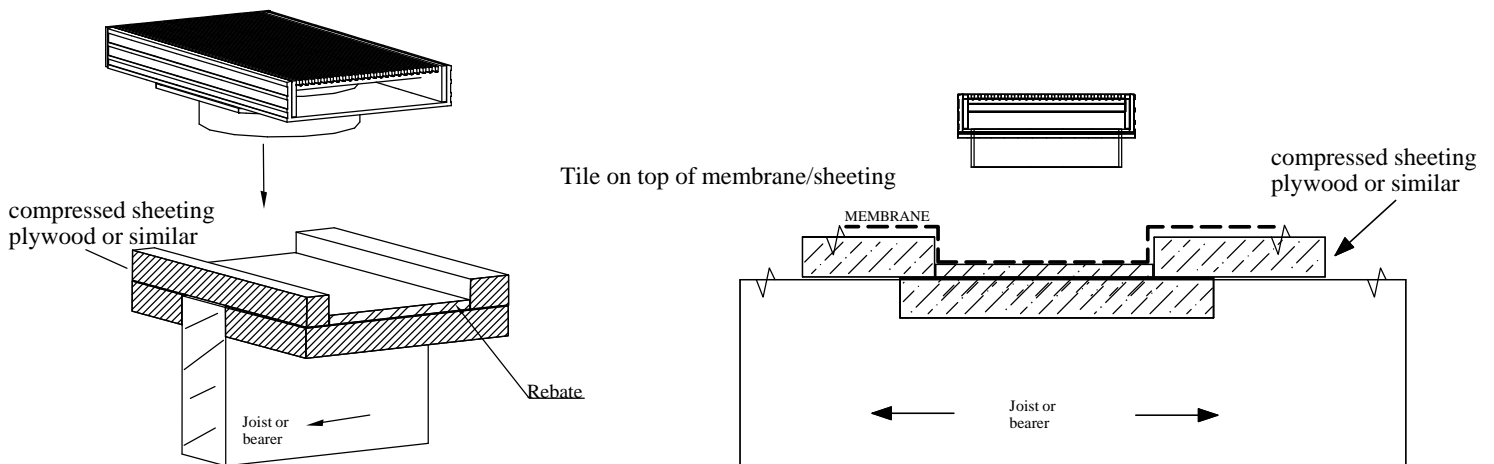

NOTE if waterproofing is required the rebate must be waterproofed before laying the 100AG system.

An F100 spigot fits in a 100 DWV pipe and should drain 1.0 L/s..... We recommend these Spigots every 2m.. not more than 1.0m from end.
The loose fitting Spigots provide an outlet for moisture in the waterproof rebate and allows the Channel to be removed for safe keeping until tiling.