

65AS TIMBER FLOOR/DECK

Standard installation

When 65AS is running parallel to joist/bearer

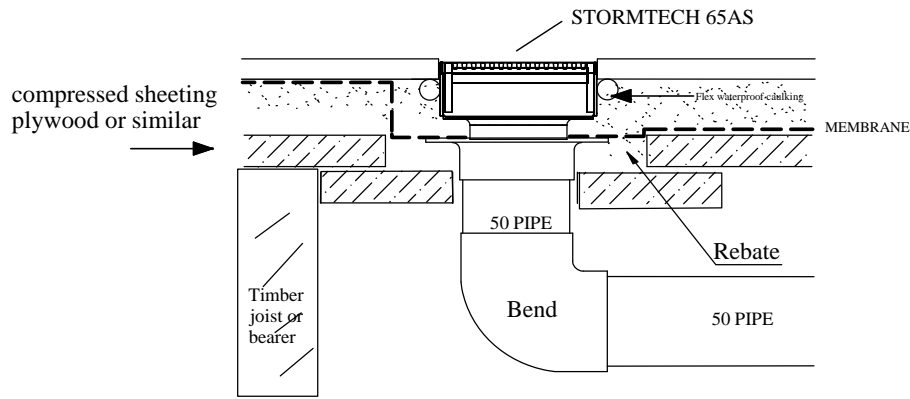

Provide access to drain pipes for cleaning

When 65AS is running perpendicular to joist/bearer

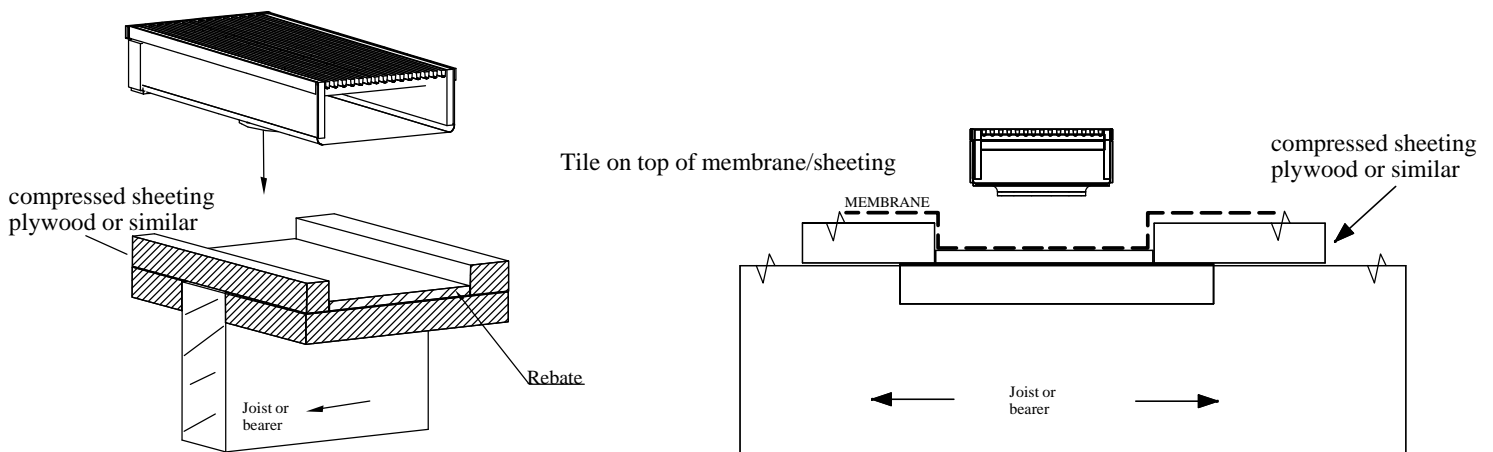

NOTE if waterproofing is required the rebate must be waterproofed before laying the 65AS system.

The 65AS spigot fits in a 50 DWV pipe and should drain 0.6 L/s..... We recommend these Spigots every 1m.. not more than 0.5m from end.
The loose fitting Spigots provide an outlet for moisture in the waterproof rebate and allows the Channel to be removed for safe keeping until tiling.